

DCT-2000 DIGITAL COMPACT
CASSETTE DECK (14-675)
SHEET # 1
FAXBACK DOC # 10038

CONTINUED
ON SHEET # 2

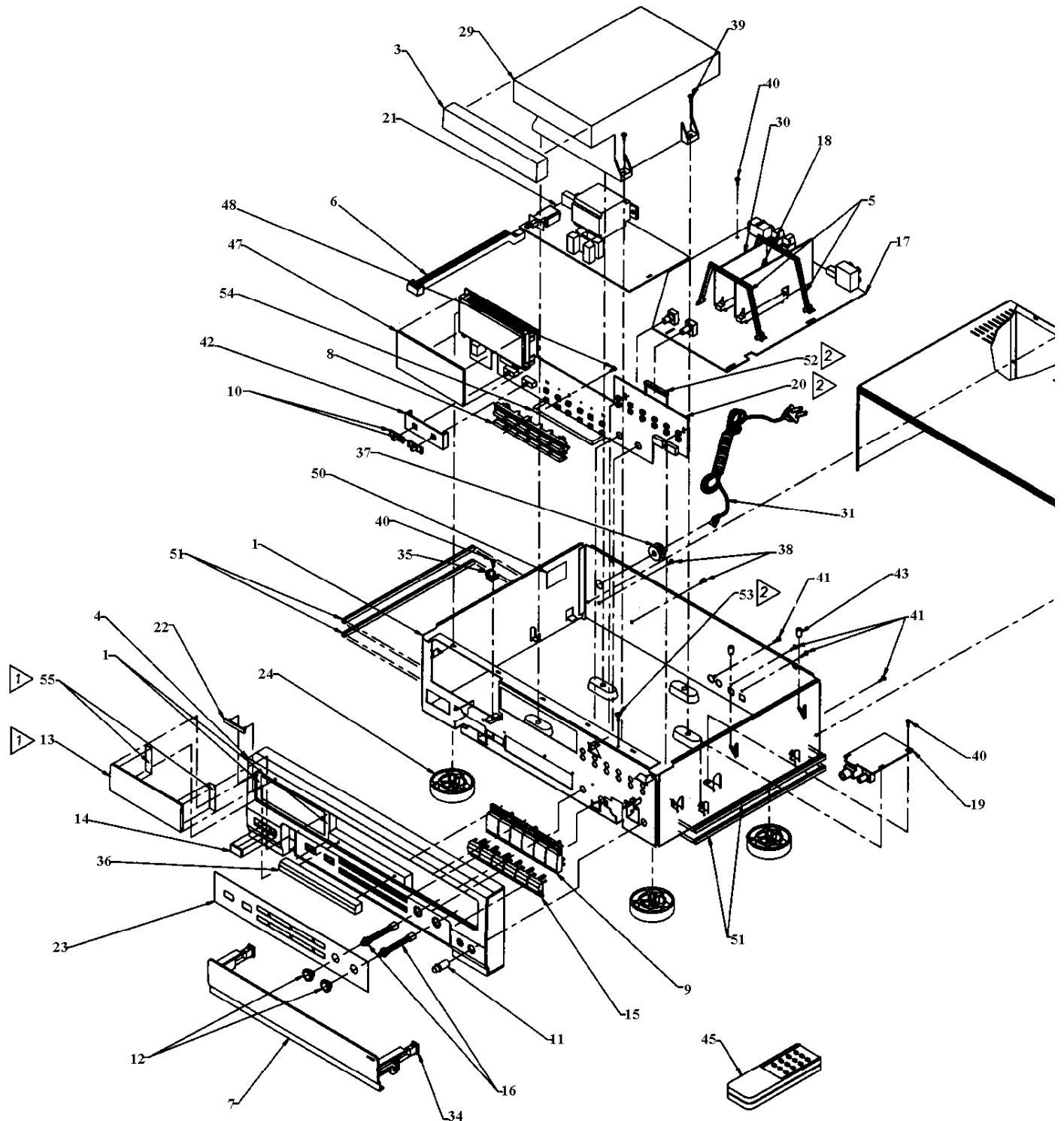

**DCT-2000 DIGITAL COMPACT
CASSETTE DECK (14-675)
SHEET # 2
FAXBACK DOC # 10038**

**CONTINUED ON
SHEET # 1**

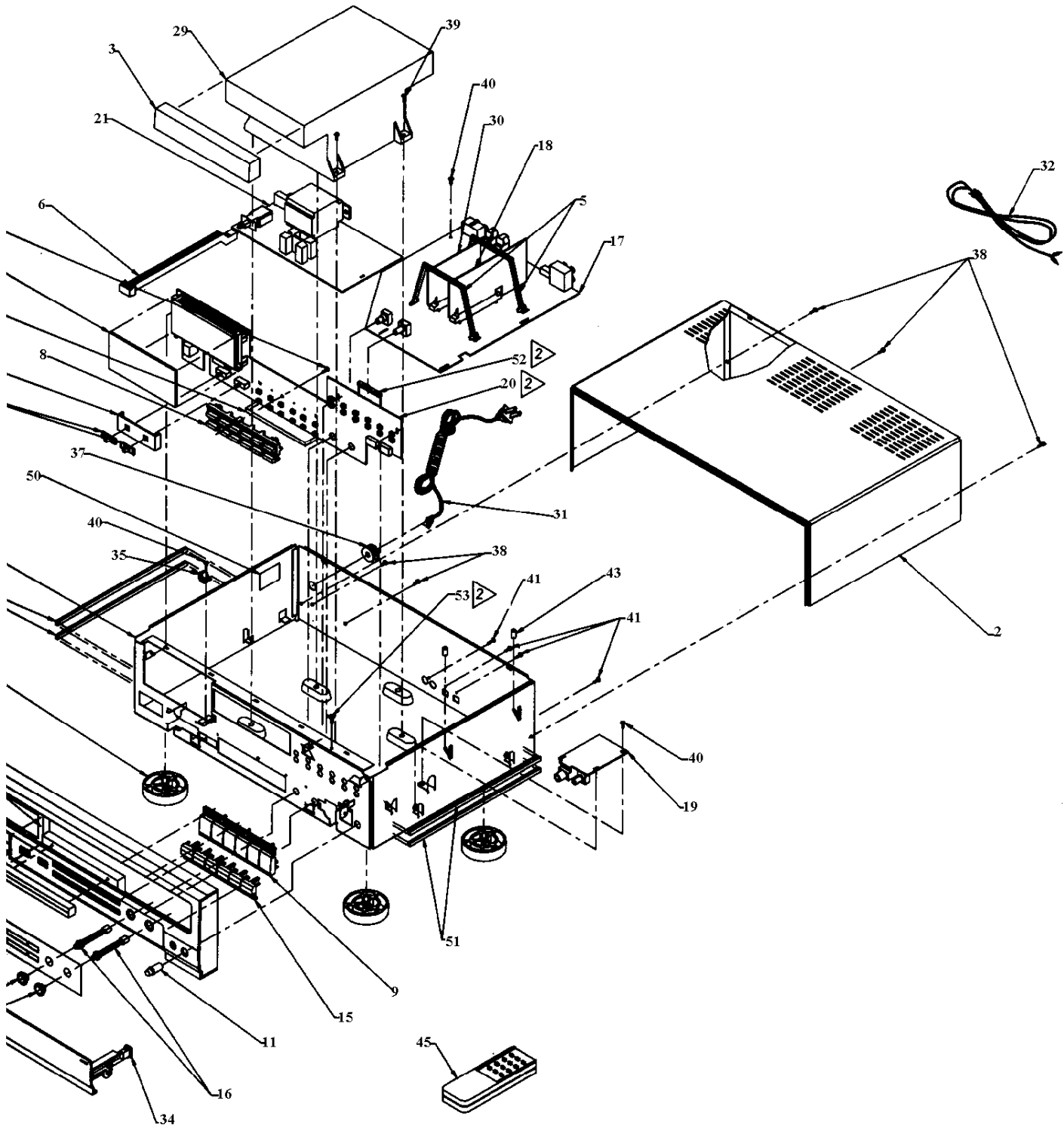

To order parts call 1-800-843-7422 or visit your local RadioShack store.

Reference #	Cat.No.	Description	NP Part #
	11318532		1N4002
	11318540		1N4003A
	11318615		1N4148
	11319027		1N5231B
Q102 Q103 Q106 Q180	10511210	USE 1TD0011	1TD0010
Q190 Q421	10511210	REPLACED BY 1TD-0011	1TD0010
Q105	10511665	USE 2SA1162GR	1TD0119
	10511665		1TD0119
Q102 Q103 Q104 Q105	10512390	XSTR MMBT3904 SOT-23 S NP	1TD0264
Q108 Q109 Q110 Q111	10512390		1TD0264
Q112 Q114 Q115	10512390		1TD0264
Q20 Q24 Q27 Q29 Q101	10512390		1TD0264
Q202 Q200 Q1 Q9 Q15	10512390		1TD0264
Q422	10512499	XSTR 2SA1162 SI PNP LO PW	1TD0292
	10512499		1TD0292
Q104	10512853	XSTR 2SD999LK SI	1TD0367
	10512853	CL22 SC-62	1TD0367
Q107 Q113	10514339	XSTR 2N3906	1TD0576
	10514339		1TD0576
Q28 Q30 Q35	10514842	XSTR MMBT 2907ALT1 PNP	1TD0629
Q3 Q10 Q16 Q25 Q26	10514842		1TD0629
	10518306	REPLACED BY MPSA13	1TR0328
Q119 Q120 Q121 Q122		TRANSISTOR PN2907	1TR0732
			1TR0732
	10520088	REPLACED BY DTC144TS	1TR0806
Q105	10511665	XSTR 2SA1162GR LOW PWR AM	2SA1162GR
	10511665		2SA1162GR
	11331584	XSTR 2SC1740 SI NPN	2SC1740
	10526440	REPLACED BY 2SC1740	2TR0360
		REPLACED BY 2SC1740	2TR1244
	10906600	IC,AN7805 VOLT REGULATOR	AN7805
	12006144	DIM1200	AX0736
150M	10550259	BELT,CAPSTAN RDV0015	B0522
053N	10550267	BELT,LOADING TRAY	B0523
099N	10550275	BELT,LOADING	B0524
	10565596	COIL CHOKE,LINE TDK 3.9UH	CA4045
CF101 CF102	10569671	FILTER,SUPPRESSION	CB0468
Q071	10585180	PHOTO UNIT,GP2S06BC	CP0347
	10585180	TAKE UP	CP0347
Q073	10585198	PHOTO UNIT,SPI-306-03	CP0348
	10585198	PHTOSENSUR UNIT	CP0348
Y1	10594414	CRYSTAL,4.194304 MHZ	CX0829
X401		CRYSTAL,24MHZ SMD-49	CX1224
X402		CRYSTAL,22.5792MHZ SMD 49	CX1225
7	10611911	DOOR,268	DB1122
	10611911	BEZEL PANEL BLACK	DB1122
D201 D206 D207 D200	10618056	DIODE LL34	DD0214
D202	10618056		DD0214
D421		DIODE 3.6V 02CZ3.6X	DD0311
	11369626		DTC144TS
	10621795	REPLACED BY 1N4148	DX0022
	10622298	REPLACED BY 1N4002	DX0206
	10622306	REPLACED BY 1N4003A	DX0207
	10622595	REPLACED BY 1N5231B	DX0311
D142	10625150	DIODE ZN IN5236RL 7.5V	DX1310
	10625150		DX1310
D002	10625655	DIODE BZV86-2V0	DX1496
	10625655	ORANGE GLASS W/BLK STRIPD	DX1496
D071	10626976	DIODE 1SS133TA RVD	DX1918
	10626976		DX1918

	10634798		DX3564
	10640126	FOOT PAD	F0475
	10643195	FILTER, FIP	G0304
	10643203	LENS, DISPLAY	G0305
	10643211	LENS, REMOTE	G0306
H702	10645646	HEAD, RECORD/PLAY DCC	H0092
010N	10658755	RETAINER KIT	HB1270
031N	10658763	CASE, CASSETTE	HB1271
	10675858	DAMPER ASSY	HC3229
025N	10688802	GUIDE, LEFT TRAY	HC6427
047N	10688885	BOARD, CONTROL MOVEMENT	HC6435
	10688885	PLASTIC	HC6435
049N	10688927	PAD, PLASTIC WHITE	HC6442
	10690006	MAGNET	HC6558
	10690105	HOLDER, DISPLAY	HC6569
	10695922	FUSE 350MA 125V FAST BLO	HF0011
		REPLACED BY HF0011	HF0352
	10697878	PKG OF 5	HF0368
	10709830	BADGE, OPTIMUS	HM0605
	10710333	LABEL, COSMETIC	HM0659
	10725414	HOS RT-01N-2.3A	J0776
J6	10725422	CONNECTOR, 10 PIN MOLEX	J0777
	10725422	53025-1010	J0777
J109 J121	10725430	CONNECTOR, CARD ED.50PN	J0778
	10725430	25X2.100 IN.NC.SP	J0778
J110 J116	10725448	CONNECTOR, ELCO	J0779
	10725448	#00-8370-121-000-800	J0779
J105	10725463	CONNCTR, PHONOJACK RCA 1X2	J0781
	10725463	GOLD PL.W/CH	J0781
J104	10725471	JACK, RCA PHONO 2X2GLD	J0782
	10725471	PL.W/NICK.GRD	J0782
J101	10727246	JACK, GOLD	J0979
	10727246	IL-402-30S-S1L-SA-1-E1500	J0979
J103	10727352	JACK, CFM-018S-ST	J0993
J071	10727378	JACK, RJS9T7ZA	J0995
J408		JACK	J1003
		IL-402-18S-S1L-SA-E1000	J1003
JW32		CONNECTOR, 3P MALE WHITE	JE0437
JW93		CONNECTOR, 6P MALE WHITE	JE0440
6	10775450	BUTTON, POWER SWITCH	K3682
9	10775468	KEYTOPPER, FUNCTION TOP	K3683
10	10775476	KNOB, DOLBY	K3684
11	10775484	KNOB, LEVEL	K3685
	10775484	VOLUME	K3685
12	10775492	KNOB, RECORD	K3686
15	10775500	KEYTOPPER, FUNCTION BOTTOM	K3687
8	10780971	DISPLAY, KEYTOPPER	K4275
U4	10790905	DISPLAY, LCD	L0139
U108	11515855	IC, LA2010 8 PIN SIP	LA2010
	11515855		LA2010
	11391612	W/HEAT SINK	LB1648
	11391943		LM393
M071	10814457	MOTOR, DC RFM133ZA CAPSTAN	MD0639
	10814457	SUB ASSY MOTOR	MD0639
M072	10814465	MOTOR, DC MMN-6F4RA88	MD0640
	10814465	FAST FORWARD/REWIND	MD0640
M051	10814473	MOTOR, DC LOADING	MD0641
	11370400		MPSA13
	10819043	MANUAL, SERVICE 14-675	MS1400675
	10840155	XEROX COPY	MU1400675
	10840163	QUICK REFERENCE GUIDE	MU1400675Q
U108		USE LA2010	MX0290
			MX0290
U117		IC, MC78M05CT VOLT REG 5V	MX0582
			MX0582
Q151	10875656	IC, TD1316T/N-T WRITE AMP	MX1079
	10875656	24 PIN SMD	MX1079

Q153 Q411		IC,UN2217 22K SEMICON COM	MX1081
		8H-R SC-59A	MX1081
	10875672	REPLACED BY TC4066BP	MX1082
Q101	10875680	IC,TDA1317 READ AMP	MX1084
	10875680	44 PIN FLAT PACK	MX1084
Q184	10875698	IC,74HC163 16P SMD	MX1085
	10875698		MX1085
Q401 Q402		IC,SAA2001 SBF-L 44P FP	MX1164
			MX1164
Q403		IC,SAA2021 SBC 44P FP	MX1174
			MX1174
Q404		IC,SAA2041 DDSP 80P FP	MX1175
			MX1175
Q405		IC,SAA2031 ERCO 44P FP	MX1217
			MX1217
Q406		IC,MB81464 64K BITX4 DRAM	MX1225
		PLCC 18 PFP	MX1225
Q409		IC,TC4538BF UPC4538BF	MX1229
		S0-16	MX1229
Q410		IC,SAA2011 ADAS 44P FP	MX1231
			MX1231
Q412		IC,74HC32 S014	MX1232
			MX1232
Q423		IC,SAA2051 DEQ2 44P FP	MX1252
			MX1252
Q441		IC,M51581FD FLAT 44P FP	MX1258
			MX1258
Q443		IC,NE5230D S08	MX1264
			MX1264
Q444		IC,74HC4046 FLAT TAPING	MX1268
		S0-16	MX1268
	10886968	IC,S87C51FB-1/R2640 CMOS	MX2771
U204 U205 U5	10887420	IC,74HC126 14 PIN SOIC	MX2834
	10887420		MX2834
U210	10890754	IC,LM358D R2	MX3375
	10890754		MX3375
U201	10892537	IC,74HC14 PRIORITY ENCODR	MX3636
	10892537		MX3636
U3 U4 U107 U110		NE5532 OP AMP	MX3679
		8 PIN DIP	MX3679
U6	10895142	IC,74HC86 SMD S0-14	MX4095
	10895142		MX4095
U23	10895977	IC,LM555CM 8P SMD SOIC-8	MX4218
	10895977		MX4218
	10896629	REPLACED BY NJM2902N	MX4335
U115	10897478	IC,74HC374A OCTAL D TYPE	MX4492
	10897478		MX4492
	11280054	T0-220 CASE	MX4660
Q183	10898930	IC,74HC00 DIP 14 T	MX4824
	10898930		MX4824
Q181	10899458	IC,74HC4053 DIP 16 T	MX4930
	10899458		MX4930
Q442	10900140	IC,74HCU04 HEX INVERTER	MX5108
	10900140	14 PIN DIP	MX5108
	10901510	REPLACED BY NJM4556D	MX5443
U210	10905115	USE MX3375	MX6194
	10906600	REPLACED BY AN7805	MX6567
U113	10906774	74HC08,14 PIN DIP	MX6613
	10906774		MX6613
Q182	10906824	IC,74HC175 SMT S016	MX6621
	10906824	16 PIN SMD	MX6621
U202	10908648	IC,LC74HC08M NAME GATE	MX7005
	10908648		MX7005
U203 Q185	10908655	IC,LC74HC02M CMOS	MX7006
	10908655		MX7006
U114	10909018	IC,74HC00 14 PIN	MX7106
	10909018		MX7106

		REPLACED BY MX7339	MX7173
	10910156		MX7339
U200	10922854	IC,MICROCONTROLLER 68H05	MX8902
	10922854		MX8902
	10923258		MX8943
	10923324		MX8950
	10923332		MX8951
	10923340		MX8952
U1	10923357	IC,UPD75236 MASKED ROM	MX8953
	10923357		MX8953
U109	10923381	IC,CXA1332S SONY DOLBY	MX8956
	10923381	ENCODER 30 PIN DIP	MX8956
	10923399	REPLACED BY LB1648	MX8957
	10923407		MX8958
	10936904	CONVERTER 28 PIN DIP	MXP1273
	10936912	CONVERTER 28 PIN DIP	MXP1274
	11392560	AMPLIFIER 14 PIN DIP	NJM2902N
	11392602		NJM4556D
R135	10960193	POT,SEMI-FIXD 1K 25%	P0258
	10960193	RH03A3A	P0258
R167	10960201	POT,SEMI-FIXD 100 OHM	P0259
	10960201	SURFACE MOUNT	P0259
R036	10960227	POT,SEMI-FIXD VR 22K VERT	P0261
	10960227	TRIMMING RESIST QUICK	P0261
RS02	10967073	POT,SEMI-FIXD VR 4.7K FWD	P1047
	10967073	VERT TRIMMING RESIST	P1047
	10967776	POT,VAR 50K DUAL 6P SIP	P1192
R227	10967800	POT,100K W/CENTER TAP	P1197
	10967800	W/DETENT	P1197
R226	10967818	POT,50KX2 NO DETENT	P1198
	10967818	NO CENTER	P1198
R121 R126	10967826	POT,SEMIFIXD 10K TRIM	P1200
	10967826	Y-085 SIZE	P1200
RS08	10969012	POT,SEMI-FIXD VR 470 OHM	P1342
	10969012	VERT TRIMMING RESIST REV	P1342
R101	10969020	POT,SEMI-FIXD 4.7K 25%	P1343
	10969020	SURFACE MOUNT	P1343
R455		POT,RES TRIMMER 10K PLL	P1358
		ADJUST	P1358
K100	10985083	RELAY,DPDT 12V TYPE G5V-2	R0156
005M	10986990	GEAR,MAIN	RA0155
020M	10987006	REEL,DAI RXR0013	RA0156
140M	10988624	GEAR,IDLE RXG0009	RA0394
141M	10988947	GEAR,REEL MOTOR RDG0034	RA0442
151M	10989838	FLYWHEEL, (F) RXF0007	RA0563
152M	10989846	FLYWHEEL, (R) 1DW0054YA	RA0564
180M	10989879	GEAR,REEL DAI RXG0003	RA0567
005N	10991065	ARM,RELEASE	RA0705
021N	10992063	ARM,FRONT TRAY	RA0863
022N	10992378	ARM,RETAINER LATCH	RA0975
029N	10992584	GEAR,LOADING RACK	RA1007
16	10992733	SHAFT,EXTENSION LEVEL	RA1034
	10992733	KNOB	RA1034
051N	10993103	PULLEY,LOADING TRAY	RA1108
055N	10993152	LEVER,PLASTIC	RA1116
059N	10994515	LEVER,UPPER TRAY	RA1332
079N	10994630	PULLEY,LOADING MOTOR	RA1347
094N	10994655	PULLEY,SECOND LOADING	RA1350
060M	11028768	ROLLER,PINCH(R) RXP0005	RD0324
090M	11028776	ROLLER,PINCH (F) RXP0004	RD0325
		MECHANISM	RM0000X
29	11046034	MODULE,DCC RECORD UNIT	RM0329
SW1 SW2	11055571	SWITCH,SLIDE SP3T ALPS	S0226
SW13 SW14 SW15 SW16	11055589	SWITCH,PUSH B.RAD	S0227
SW17 SW18 SW19 SW20	11055589	HT=4.3MM .2 LS T/R	S0227
SW21 SW22 SW23 SW24	11055589		S0227
SW3 SW4 SW5 SW6 SW7	11055589		S0227

SW31 SW32	11055589		S0227
SW8 SW9 SW10 SW11 SW12	11055589		S0227
S071	11056595	SWITCH, LEAF MINI MODE	S0337
	11056595	RSH1A89ZC-U	S0337
S072	11056645	SWITCH, LEAF MINI TAPE IN	S0342
	11056645	RSH1A90YC-U	S0342
S091	11056652	SWITCH, PUSH LENGTH RSP	S0343
	11056652	1C001-A	S0343
S092	11056660	SWITCH, PUSH DCC RSP	S0345
	11056660	1B001-A	S0345
S051 S052	11056678	SWITCH, SLIDE LOAD START	S0346
	11074051	SWITCH, PUSH POWER ON/OFF	SD0149
L071	11080991	SOLENOID, COIL TRIGGER	SJ0067
	11080991	RSJ0003	SJ0067
L072	11081007	SOLENOID, COIL BRAKE	SJ0068
R187	11090131	THERMISTOR, 40 OHM	T0135
	11090131	ERT-D3FFL400S	T0135
RS03	11090156	THERMISTOR, 130 OHM	T0137
	11090156	ERT-D3FGL131S	T0137
	11096567	POWER SUPPLY	TA0717
T100	11096633	TRANSFORMER	TA0727
	11096690	TRANSFORMER, POWER	TA0734
	11393212		TC4066BP
WM01	11106242	JUMPER, LEAD 9P 220MM	W0011
27	11108370	CABLE ASSY, AUDIO-HEADPHON	W0282
31	11108560	CORD, P BLK 6FT POLARIZED	W0304
33	11108578	CABLE, FFC 12 CONDUCTOR	W0305
	11108578	FLAT FLEXIBLE CABLE	W0305
28	11108586	CABLE ASSY	W0306
	11108586	RECORD MODULE #1	W0306
26	11108594	CABLE ASSY	W0307
	11108594	RECORD MODULE #2	W0307
25	11108602	CABLE ASSY	W0308
	11108602	RECORD MODULE #3	W0308
32	11108610	CABLE ASSY, AUDIO PATCH	W0309
	11108610	3FT LENGTH	W0309
	11113339	FIT WIRE (JUMPER LEAD)	W1014
		MODULE SEE AX0736	X0000X
	11160637	PCB, CONTROLLER BOARD	XB4787
19	11160645	PCB, HEADPHONE BOARD	XB4788
20	11161007	PCB ASSY	XB4825
	11161007	DCC DISPLAY	XB4825
17	11161015	PCB ASSY	XB4826
	11161015	DCC AUDIO BOARD	XB4826
30		PCB, DCC DIGITAL MODULE	XB5130
		COMPLETE	XB5130
	11164001	PCB, PW03 READ/WRITE	XB5153
	11164019	PCB ASSY, PK01 SWITCH	XB5154
	11164027	SWITCH	XB5155
	11164035	TRAY WIRE PM03	XB5156
015N	11204856	TRAY KIT	Z5034
018N	11204872	ESCUTCHEON, FRONT PANEL	Z5036
035N	11204997	CHASSIS, LOADING	Z5048
2	11212248	CHASSIS, ENCLOSURE	Z5900
	11212248	TOP CASE	Z5900
3	11212255	BEZEL, DRIVE	Z5901
	11212255	W/LOGO DEC	Z5901
4	11212263	BEZEL, FRONT 268	Z5902
36	11212271	BEZEL, LOWER	Z5903
45	11229200	REMOTE CONTROL, TRANSMITTR	ZA0138

(This list was generated on 07/08/2005)

[Privacy Policy](#)